

DDLDF-520

2023/03/22

Outline

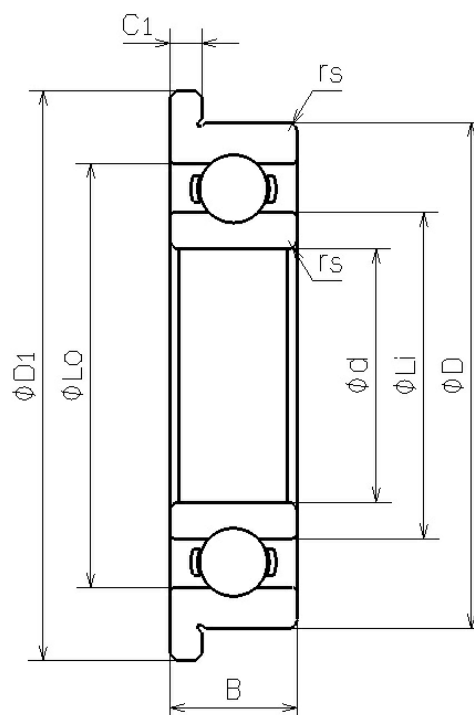

NMB Parts No.	DDLDF-520
Metric or Inch	Metric
ISO/JIS	F682
Material of Rings	Stainless Steel
Ring Type	[Radial] Flanged
Inner Diameter (d) [mm]	2.000
Outer Diameter (D) [mm]	5.000
Width	

DDLDF-520

2023/03/22

(B) [mm]	1.500
Chamfer (rs min) [mm]	0.080
Flange Diameter (D1) [mm]	6.100
Flange Width (C1) [mm]	0.500
Reference Diameter Outer (Lo) [mm]	4.000
Reference Diameter Inner (Li) [mm]	2.900
Ball Size (DW) [mm]	0.7938
Ball Complement (Z)	7
Dynamic Load Rating (Cr) [N]	187
Static Load Rating (Cor) [N]	59
Inner Diameter (d) [in]	0.0787
Outer Diameter (D) [in]	0.1969
Flange Diameter (D1) [in]	0.2402
Flange Width (C1) [in]	0.0197