

## DDR-2

2023/03/22

## Outline

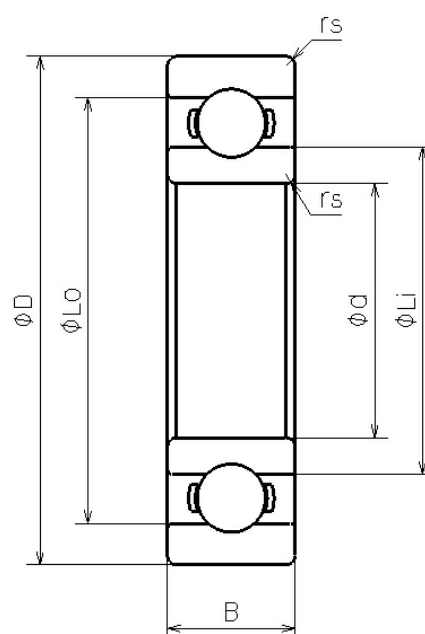

NMB Parts No.	DDR-2
Metric or Inch	Inch
ISO/JIS	-
Material of Rings	Stainless Steel
Ring Type	[Radial] Standard
Inner Diameter (d) [mm]	3.175
Outer Diameter (D) [mm]	9.525
Width	

## DDR-2

2023/03/22

(B) [mm]	3.967
Chamfer (rs min) [mm]	0.300
Reference Diameter Outer (Lo) [mm]	7.650
Reference Diameter Inner (Li) [mm]	5.080
Ball Size (DW) [mm]	1.5875
Ball Complement (Z)	7
Dynamic Load Rating (Cr) [N]	641
Static Load Rating (Cor) [N]	226
Inner Diameter (d) [in]	0.1250
Outer Diameter (D) [in]	0.3750