

## DDRF-620

2023/03/22

## Outline

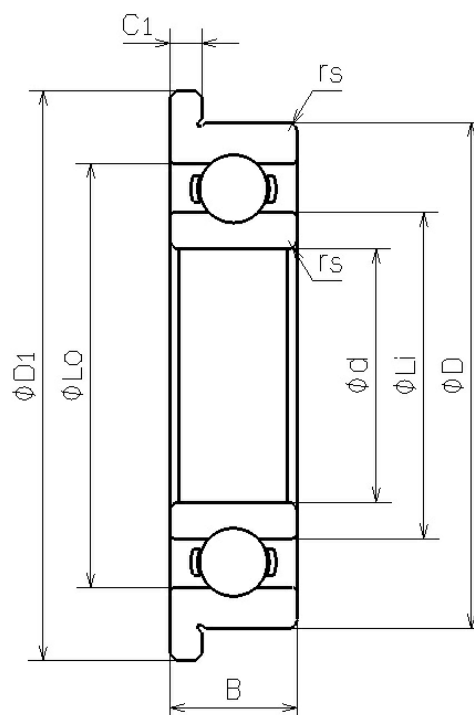

NMB Parts No.	DDRF-620
Metric or Inch	Metric
ISO/JIS	F692
Material of Rings	Stainless Steel
Ring Type	[Radial] Flanged
Inner Diameter (d) [mm]	2.000
Outer Diameter (D) [mm]	6.000
Width	

## DDRF-620

2023/03/22

(B) [mm]	2.300
Chamfer (rs min) [mm]	0.150
Flange Diameter (D1) [mm]	7.500
Flange Width (C1) [mm]	0.600
Reference Diameter Outer (Lo) [mm]	4.750
Reference Diameter Inner (Li) [mm]	3.160
Ball Size (DW) [mm]	1.0000
Ball Complement (Z)	7
Dynamic Load Rating (Cr) [N]	279
Static Load Rating (Cor) [N]	89
Inner Diameter (d) [in]	0.0787
Outer Diameter (D) [in]	0.2362
Flange Diameter (D1) [in]	0.2953
Flange Width (C1) [in]	0.0236