

03010SS

General purpose

2023/12/27

General Specifications



Motor Protection: Auto Restart / Polarity Protection
 Insulation Resistance: 10M ohm or over with a DC500V Megger
 Dielectric Withstand Voltage: AC700V 1s
 Allowable Ambient Temperature Range : -10deg.C - +70deg.C (Operating)
 -40deg.C - +70deg.C (Storage)
 non-condensing environment

Expected Life

40deg.C 30,000 Hours *Failure Rate 10% (L10 Life)

Outline

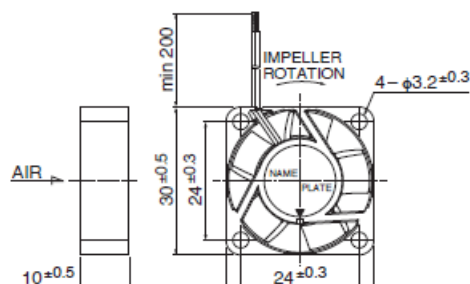

Panel Out-cuts

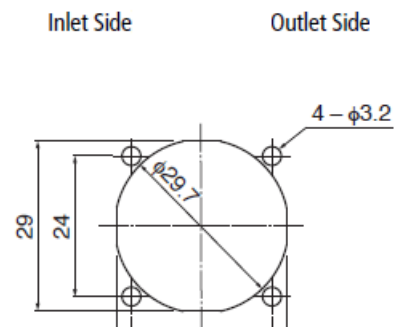

03010SS

General purpose

2023/12/27



Characteristic Curves

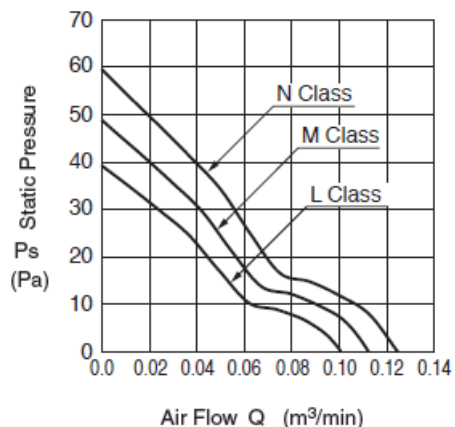

Material

Casing: Plastic (Black) UL94V-0

Impeller: Plastic (Black) UL94V-0

Bearing: Sleeve

BearingLead Wire: UL1061 AWG26 +: Red, -: Black

Specifications

| Model | Product No | Nominal Voltage [V] | Operating Voltage lower limit [V] | Operating Voltage upper limit [V] | Current [A] | Input Power [W] |
|-------------------|------------|---------------------|-----------------------------------|-----------------------------------|-------------|-----------------|
| 03010SS-05L-AA-00 | 00 | 5 | 4.5 | 5.5 | 0.12 | 0.60 |
| 03010SS-05M-AA-00 | 00 | 5 | 4.5 | 5.5 | 0.16 | 0.80 |

03010SS

General purpose

2023/12/27

| | | | | | | |
|-------------------|----|----|-----|------|------|------|
| 03010SS-05N-AA-00 | 00 | 5 | 4.5 | 5.5 | 0.21 | 1.05 |
| 03010SS-12L-AA-00 | 00 | 12 | 7.0 | 13.2 | 0.06 | 0.72 |
| 03010SS-12M-AA-00 | 00 | 12 | 7.0 | 13.2 | 0.07 | 0.84 |
| 03010SS-12N-AA-00 | 00 | 12 | 6.0 | 13.2 | 0.08 | 0.96 |

| Model | Speed [min-1] | Max. Air Flow [m3/min] | Max. Air Flow [CFM] | Max. Static Pressure [Pa] | Max. Static Pressure [In H2O] | Noise [dB] | Mass [g] |
|-------------------|------------------|---------------------------|------------------------|------------------------------|----------------------------------|---------------|-------------|
| 03010SS-05L-AA-00 | 8500 | 0.10 | 3.50 | 38.0 | 0.15 | 23.5 | 8.5 |
| 03010SS-05M-AA-00 | 9500 | 0.11 | 3.90 | 48.0 | 0.19 | 26.0 | 8.5 |
| 03010SS-05N-AA-00 | 10500 | 0.12 | 4.20 | 59.0 | 0.24 | 28.0 | 8.5 |
| 03010SS-12L-AA-00 | 8500 | 0.10 | 3.50 | 38.0 | 0.15 | 26.0 | 8.5 |
| 03010SS-12M-AA-00 | 9500 | 0.11 | 3.90 | 48.0 | 0.19 | 30.0 | 8.5 |
| 03010SS-12N-AA-00 | 10500 | 0.12 | 4.20 | 59.0 | 0.24 | 34.0 | 8.5 |

Rotation: Clockwise as seen from the label side

Airflow Outlet: Label side

*1: Average Values in Free Air