

04010SS

General purpose

2023/12/27

General Specifications



- Motor Protection: Auto Restart / Polarity Protection
- Insulation Resistance: 10M ohm or over with a DC500V Megger
- Dielectric Withstand Voltage: AC700V 1s
- Allowable Ambient Temperature Range : -10deg.C - +70deg.C (Operating)
- 40deg.C - +70deg.C (Storage)
- non-condensing environment

Expected Life

40deg.C 30,000 Hours *Failure Rate 10% (L10 Life)

Outline

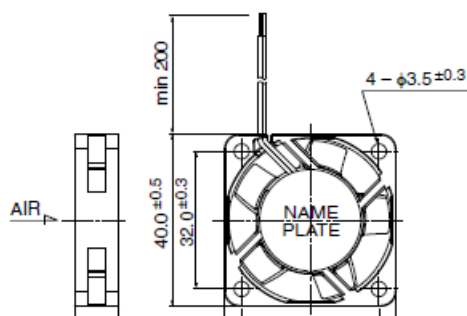

Panel Out-cuts

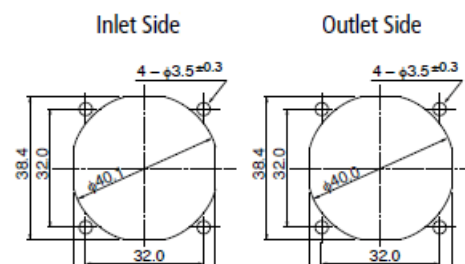

04010SS

General purpose

2023/12/27



Characteristic Curves

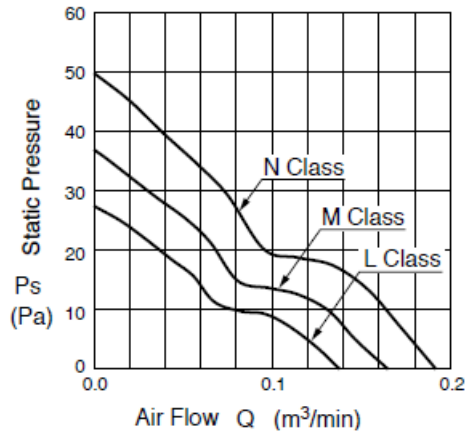

Material

Casing: Plastic (Black) UL94V-0

Impeller: Plastic (Black) UL94V-0

Bearing: Sleeve

Bearing Lead Wire: UL1061 AWG26 +: Red, -: Black

Specifications

Model	Product No	Nominal Voltage [V]	Operating Voltage lower limit [V]	Operating Voltage upper limit [V]	Current [A]	Input Power [W]
04010KA-12N-AA-00	00	12	10.2	13.8	0.07	0.88
04010SS-05L-AA-00	00	5	4.5	5.5	0.09	0.45

04010SS

General purpose

2023/12/27

04010SS-05M-AA-00	00	5	4.5	5.5	0.13	0.65
04010SS-05N-AA-00	00	5	4.5	5.5	0.17	0.85
04010SS-12L-AA-00	00	12	10.2	13.8	0.03	0.40
04010SS-12M-AA-00	00	12	10.2	13.8	0.05	0.60
04010SS-12N-AA-00	00	12	10.2	13.8	0.06	0.71
04010SS-24L-AA-00	00	24	20.0	26.4	0.02	0.58
04010SS-24M-AA-00	00	24	20.0	26.4	0.03	0.70
04010SS-24N-AA-00	00	24	20.0	26.4	0.05	1.10

Model	Speed [min-1]	Max. Air Flow [m3/min]	Max. Air Flow [CFM]	Max. Static Pressure [Pa]	Max. Static Pressure [In H2O]	Noise [dB]	Mass [g]
04010KA-12N-AA-00	6500	0.17	6.00	46.0	0.18	29.0	15.0
04010SS-05L-AA-00	5500	0.14	4.90	27.5	0.11	21.0	16.0
04010SS-05M-AA-00	6500	0.16	5.60	37.0	0.15	24.0	16.0
04010SS-05N-AA-00	7500	0.19	6.70	50.0	0.20	29.0	16.0
04010SS-12L-AA-00	5500	0.14	4.90	27.5	0.11	21.0	16.0
04010SS-12M-AA-00	6500	0.16	5.60	37.0	0.15	24.0	16.0
04010SS-12N-AA-00	7500	0.19	6.70	50.0	0.20	29.0	16.0
04010SS-24L-AA-00	5500	0.14	4.90	27.5	0.11	21.0	16.0
04010SS-24M-AA-00	6500	0.16	5.60	37.0	0.15	24.0	16.0
04010SS-24N-AA-00	7500	0.19	6.70	50.0	0.20	29.0	16.0

Rotation: Clockwise as seen from the label side

Airflow Outlet: Label side

*1: Average Values in Free Air