

05015SS

General purpose

2023/12/27

General Specifications

Motor Protection: Auto Restart / Polarity Protection

Insulation Resistance: 10M ohm or over with a DC500V Megger

Dielectric Withstand Voltage: AC700V 1s

Allowable Ambient Temperature Range : -10deg.C - +70deg.C (Operating)

-40deg.C - +70deg.C (Storage)

non-condensing environment

Expected Life

40deg.C 40,000 Hours *Failure Rate 10% (L10 Life)

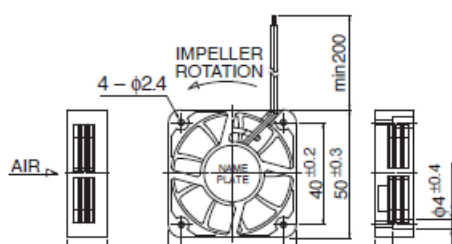
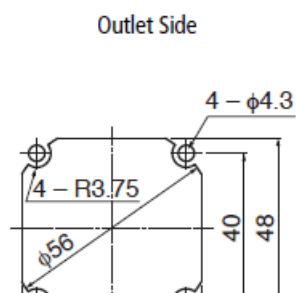
Outline**Panel Out-cuts**

ミネベアミツミ株式会社

Copyright©MinebeaMitsumi Inc. All right reserved.

05015SS

General purpose

2023/12/27

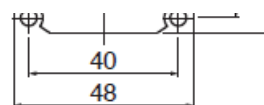
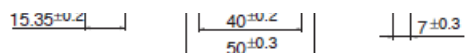

Characteristic Curves

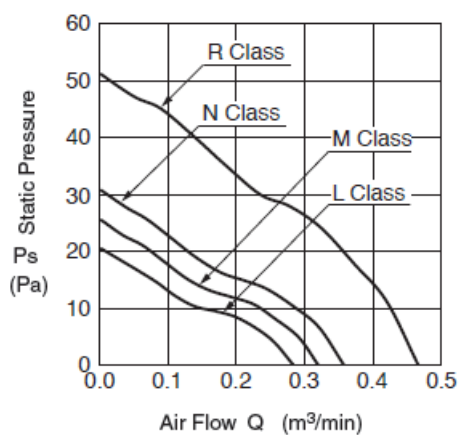

Material

Casing: Plastic (Black) UL94V-0

Impeller: Plastic (Black) UL94V-0

Bearing: Sleeve

Bearing Lead Wire: UL1061 AWG26 +: Red, -: Black

Specifications

| Model | Product No | Nominal Voltage [V] | Operating Voltage lower limit [V] | Operating Voltage upper limit [V] | Current [A] | Input Power [W] |
|-------------------|------------|---------------------|-----------------------------------|-----------------------------------|-------------|-----------------|
| 05015SS-12L-WA-D0 | D0 | 12 | 6.0 | 13.8 | 0.05 | 0.60 |
| 05015SS-12M-WA- | - | - | - | - | - | - |

05015SS

General purpose

2023/12/27

| | | | | | | |
|-------------------|----|----|------|------|------|------|
| D0 | D0 | 12 | 6.0 | 13.8 | 0.06 | 0.72 |
| 05015SS-12N-WA-D0 | D0 | 12 | 6.0 | 13.8 | 0.07 | 0.84 |
| 05015SS-12R-WA-D0 | D0 | 12 | 6.0 | 13.8 | 0.14 | 1.68 |
| 05015SS-24L-WA-D0 | D0 | 24 | 12.0 | 26.4 | 0.04 | 0.84 |
| 05015SS-24M-WA-D0 | D0 | 24 | 12.0 | 26.4 | 0.04 | 0.96 |
| 05015SS-24N-WA-D0 | D0 | 24 | 12.0 | 26.4 | 0.05 | 1.20 |
| 05015SS-24R-WA-D0 | D0 | 24 | 12.0 | 26.4 | 0.09 | 2.16 |

| Model | Speed [min-1] | Max. Air Flow [m ³ /min] | Max. Air Flow [CFM] | Max. Static Pressure [Pa] | Max. Static Pressure [In H ₂ O] | Noise [dB] | Mass [g] |
|-------------------|------------------|--|------------------------|------------------------------|---|---------------|-------------|
| 05015SS-12L-WA-D0 | 4050 | 0.25 | 8.80 | 20.0 | 0.08 | 22.0 | 25.0 |
| 05015SS-12M-WA-D0 | 4550 | 0.28 | 9.90 | 25.0 | 0.10 | 25.0 | 25.0 |
| 05015SS-12N-WA-D0 | 5050 | 0.31 | 10.90 | 31.0 | 0.12 | 27.5 | 25.0 |
| 05015SS-12R-WA-D0 | 6550 | 0.42 | 14.80 | 51.0 | 0.20 | 35.5 | 25.0 |
| 05015SS-24L-WA-D0 | 4050 | 0.25 | 8.80 | 20.0 | 0.08 | 22.0 | 25.0 |
| 05015SS-24M-WA-D0 | 4550 | 0.28 | 9.90 | 25.0 | 0.10 | 25.0 | 25.0 |
| 05015SS-24N-WA-D0 | 5050 | 0.31 | 10.90 | 31.0 | 0.12 | 27.5 | 25.0 |
| 05015SS-24R-WA-D0 | 6550 | 0.42 | 14.80 | 51.0 | 0.20 | 35.5 | 25.0 |

Rotation: Counter clockwise as seen from the label side

Airflow Outlet: Label side

*1: Average Values in Free Air