

06025VE Potting II

Industrial

2023/12/27

General Specifications



Motor Protection: Auto Restart / Polarity Protection
 Insulation Resistance: 10M ohm or over with a DC500V Megger
 Dielectric Withstand Voltage: AC700V 1s
 Allowable Ambient Temperature Range : -10deg.C - +70deg.C (Operating)
 -40deg.C - +70deg.C (Storage)
 non-condensing environment IP Code: IP68

Expected Life

60deg.C 40,000 Hours *Failure Rate 10% (L10 Life)

Outline

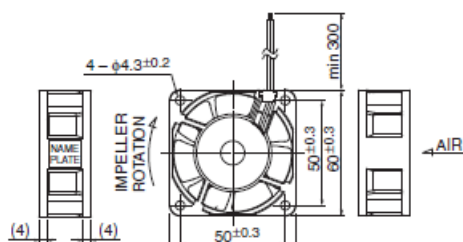

Panel Out-cuts

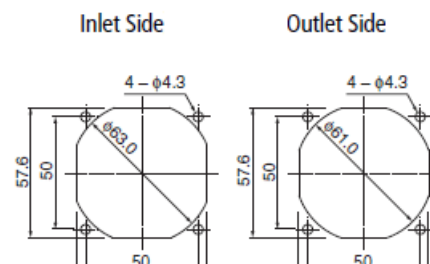

06025VE Potting II

Industrial

2023/12/27

25±0.5

60±0.3

57.6

57.6

* Outline is C (Rib) type.

Characteristic Curves

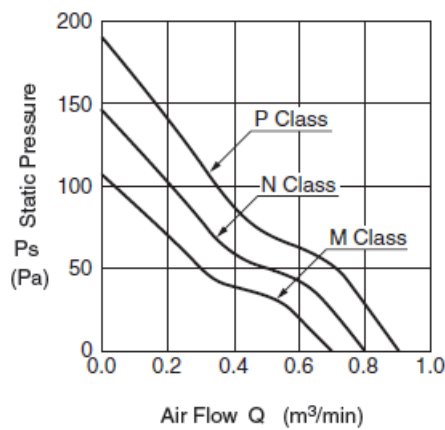

Material

Casing: Plastic (Black) UL94V-0

Impeller: Plastic (Black) UL94V-0

Bearing: Ball

BearingLead Wire: UL3385 AWG26 +: Red, -: Black

Specifications

Model	Product No	Nominal Voltage [V]	Operating Voltage lower limit [V]	Operating Voltage upper limit [V]	Current [A]	Input Power [W]
06025VE-12M-□AD-0	0	12	7.0	13.2	0.15	1.80
06025VE-12N-□AD-	0	12	7.0	13.2	0.22	2.64

06025VE Potting II

Industrial

2023/12/27

Model	Speed [min-1]	Max. Air Flow [m3/min]	Max. Air Flow [CFM]	Max. Static Pressure [Pa]	Max. Static Pressure [In H2O]	Noise [dB]	Mass [g]
06025VE-12P-□AD-0	0	12	7.0	13.2	0.40	4.80	
06025VE-24M-□AD-0	0	24	10.0	27.6	0.10	2.40	
06025VE-24N-□AD-0	0	24	10.0	27.6	0.14	3.36	
06025VE-24P-□AD-0	0	24	10.0	27.6	0.19	4.56	

Model	Speed [min-1]	Max. Air Flow [m3/min]	Max. Air Flow [CFM]	Max. Static Pressure [Pa]	Max. Static Pressure [In H2O]	Noise [dB]	Mass [g]
06025VE-12M-□AD-0	6000	0.68	24.00	107.0	0.42	42.0	90.0
06025VE-12N-□AD-0	7000	0.79	27.80	145.7	0.58	46.0	90.0
06025VE-12P-□AD-0	8000	0.90	31.70	190.3	0.76	49.0	90.0
06025VE-24M-□AD-0	6000	0.68	24.00	107.0	0.42	42.0	90.0
06025VE-24N-□AD-0	7000	0.79	27.80	145.7	0.58	46.0	90.0
06025VE-24P-□AD-0	8000	0.90	31.70	190.3	0.76	49.0	90.0

Rotation: Clockwise as seen from the spoke side

Airflow Outlet: Spoke side

*1: Average Values in Free Air

□ = Casing Form C : Rib Type、G : Flange Type