

# 11938KA

General purpose

2023/12/27

## General Specifications



Motor Protection: Auto Restart / Polarity Protection

Insulation Resistance: 10M ohm or over with a DC500V Megger

Dielectric Withstand Voltage: AC700V 1s

Allowable Ambient Temperature Range : L、 M

Class:

-10deg.C - +70deg.C (Operating)

N Class:

-10deg.C - +40deg.C (Operating)

-40deg.C - +70deg.C (Storage) non-condensing environment

## Expected Life

25deg.C 100,000 Hours \*Failure Rate 10% (L10 Life)

## Outline



## Panel Out-cuts

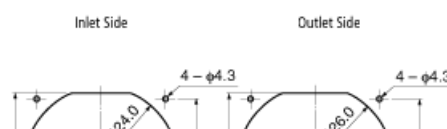

ミネベアミツミ株式会社

Copyright©MinebeaMitsumi Inc. All right reserved.

# 11938KA

General purpose

2023/12/27

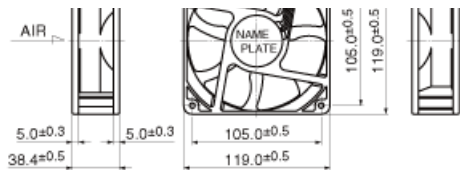

\* Outline is E (Flange) type.

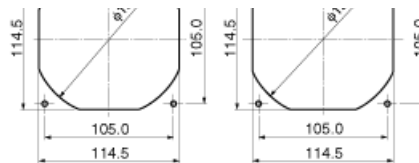

## Characteristic Curves

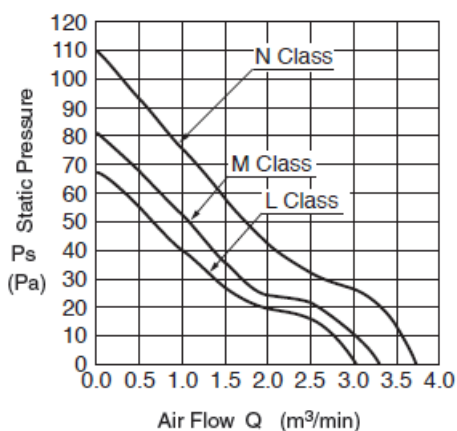

## Material

Casing: Plastic (Black) UL94V-0

Impeller: Plastic (Black) UL94V-0

Bearing: Ball

BearingLead Wire: UL1007 AWG24 +: Red, -: Black

\* Customize service for IP compatible type and Oil-proof type is available for this item.

Please contact to our sales representative for more detail.

## Specifications

	Nominal	Operating	Operating	Input
--	---------	-----------	-----------	-------

## 11938KA

General purpose

2023/12/27

Model	Product No	Voltage [V]	Voltage lower limit [V]	Voltage upper limit [V]	Current [A]	Power [W]
11938KA-12L-□A-00	00	12	6.0	13.8	0.55	6.60
11938KA-12M-□A-00	00	12	6.0	13.8	0.70	8.40
11938KA-12N-□A-00	00	12	9.5	12.6	1.00	12.00
11938KA-24L-□A-00	00	24	10.0	27.6	0.31	7.44
11938KA-24M-□A-00	00	24	10.0	27.6	0.35	8.40
11938KA-24N-□A-00	00	24	18.0	25.0	0.50	12.00
11938KA-48L-□A-00	00	48	25.0	55.2	0.16	7.68
11938KA-48M-□A-00	00	48	25.0	50.0	0.20	9.60

Model	Speed [min <sup>-1</sup> ]	Max. Air Flow [m <sup>3</sup> /min]	Max. Air Flow [CFM]	Max. Static Pressure [Pa]	Max. Static Pressure [In H <sub>2</sub> O]	Noise [dB]	Mass [g]
11938KA-12L-□A-00	2950	3.07	108.40	68.1	0.27	42.5	260.0
11938KA-12M-□A-00	3200	3.34	117.90	81.4	0.33	46.5	260.0
11938KA-12N-□A-00	3600	3.68	129.90	110.0	0.44	50.0	260.0
11938KA-24L-□A-00	2950	3.07	108.40	68.1	0.27	42.5	260.0
11938KA-24M-□A-00	3200	3.34	117.90	81.4	0.33	46.5	260.0
11938KA-24N-□A-00	3600	3.68	129.90	110.0	0.44	50.0	260.0
11938KA-48L-□A-00	2950	3.07	108.40	68.1	0.27	42.5	260.0
11938KA-48M-□A-00	3200	3.34	117.90	81.3	0.33	46.5	260.0

Rotation: Clockwise as seen from the label side

Airflow Outlet: Label side

\*1: Average Values in Free Air

□ : Casing Form    A : Rib Type    E : Flange Type

# 11938KA

General purpose

2023/12/27

□ = casing form A : RID type, E : flange type