

# 12038VA(E-Type)

Industrial

2023/12/27

## General Specifications



Motor Protection: Auto Restart / Polarity Protection  
 Insulation Resistance: 10M ohm or over with a DC500V Megger  
 Dielectric Withstand Voltage: AC700V 1s  
 Allowable Ambient Temperature Range : M, N, P, Q Class:  
 -10deg.C - +70deg.C (Operating) R Class:  
 -10deg.C - +60deg.C (Operating)  
 -40deg.C - +70deg.C (Storage)  
 non-condensing environment

## Expected Life

60deg.C 40,000 Hours \*Failure Rate 10% (L10 Life)

## Outline

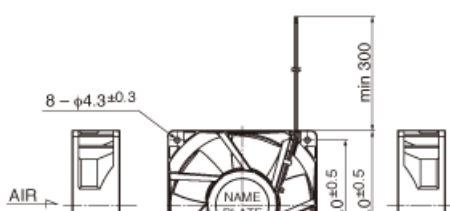

## Panel Out-cuts

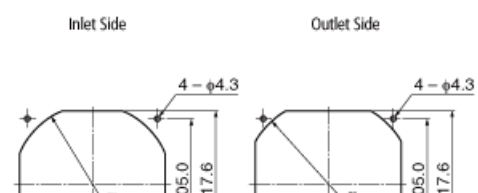

# 12038VA(E-Type)

Industrial

2023/12/27



## Characteristic Curves

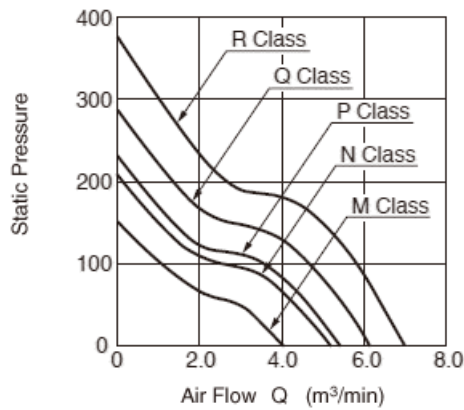

## Material

Casing: Plastic (Black) UL94V-0

Impeller: Plastic (Black) UL94V-0

Bearing: Ball

Bearing Lead Wire: UL1061 AWG24 +: Red, -: Black

\* Customize service for IP compatible type and Oil-proof type is available for this item.

Please contact to our sales representative for more detail.

## Specifications

Model	Product No	Nominal Voltage [V]	Operating Voltage lower limit	Operating Voltage upper limit	Current [A]	Input Power [W]
-------	------------	---------------------	-------------------------------	-------------------------------	-------------	-----------------

## 12038VA(E-Type)

Industrial

2023/12/27

			[V]	[V]		
12038VA-24M- □AE-0	0	24	18.0	27.6	0.45	10.80
12038VA-24N-□AE- 0	0	24	18.0	27.6	0.74	17.76
12038VA-24P-□AE- 0	0	24	18.0	27.6	0.74	17.76
12038VA-24Q-□AE- 0	0	24	18.0	27.6	1.04	24.96
12038VA-24R-□AE- 0	0	24	18.0	27.6	1.48	35.52

Model	Speed [min- 1]	Max. Air Flow [m3/min]	Max. Air Flow [CFM]	Max. Static Pressure [Pa]	Max. Static Pressure [In H2O]	Noise [dB]	Mass [g]
12038VA-24M- □AE-0	3800	4.00	141.20	150.0	0.60	53.0	370.0
12038VA-24N- □AE-0	4700	5.17	182.60	207.0	0.83	59.0	370.0
12038VA-24P- □AE-0	5000	5.35	188.90	235.0	0.94	60.0	370.0
12038VA-24Q- □AE-0	5700	6.11	215.70	287.0	1.15	63.0	370.0
12038VA-24R- □AE-0	6400	6.90	243.60	370.0	1.49	66.0	370.0

Rotation: Clockwise as seen from the label side

Airflow Outlet: Label side

\*1: Average Values in Free Air

□ = Casing Form A : Rib Type、 E : Flange Type