

F250A Series

2023/12/27

General Specifications



Motor Protection: Locked rotor, Reverse polarity

Insulation Resistance: 10M Ohm min, measured with 500V DC between all leads shorted together and case

Dielectric Withstand Voltage: AC500V 1minute

Allowable Ambient Temperature Range:

-30 deg.C - +70 deg.C (Operating)

-40 deg.C - +80 deg.C (Storage)

non-condensing environment

Expected Life

40 deg.C 70,000hours (L10)

Outline

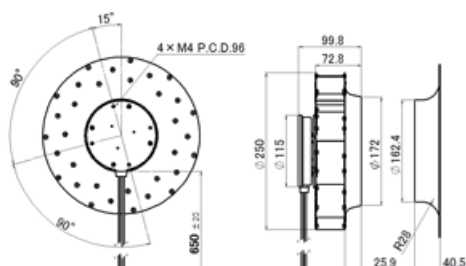

Panel Out-cuts

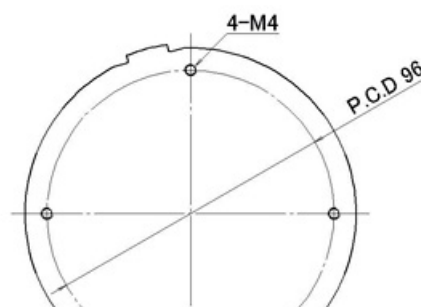

F250A Series

2023/12/27

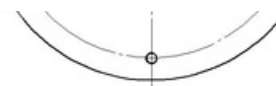

Characteristic Curves

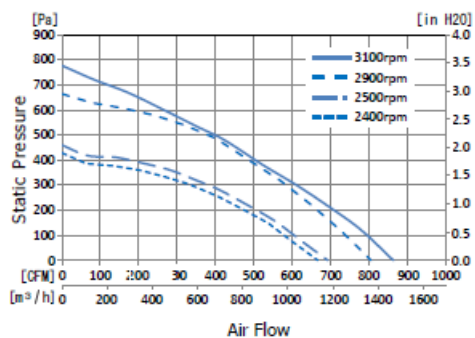

Material

Impeller: Steel

Bearing: Ball Bearings

Lead Wire: UL1015 AWG18 +: Red - : Black

Speed Control: Yellow

Speed Signal: White

Specifications

Model	Nominal Voltage [V]	Operating Voltage lower limit [V]	Operating Voltage upper limit [V]	Nominal Current [A]	Input Power [W]	Speed [rpm]
F250A3-072-D0730	48	36	72	3.4	163.2	3100
F250A4-072-D0720	48	36	72	1.9	91.2	2500
F250A5-072-D0520	24	18	30	6.1	146.4	2900

F250A Series

2023/12/27

Model	Maximum airflow [m ³ /min]	Max. Air Flow [CFM]	Max. Static Pressure [Pa]	Max. Static Pressure [In H ₂ O]	Noise [dB]	Mass [g]
F250A3-072-D0730	24.4	862	777	3.1	81	2400
F250A4-072-D0720	19.6	693	511	2.0	74	2400
F250A5-072-D0520	22.8	806	664	2.7	78	2400
F250A6-072-D0520	18.9	668	476	1.9	73	2400

*1 Average values in free air and rated voltage condition.