

SPECIFICATIONS

Summing type junction Box

B-307-※

SPEC.No. EN353307-E

1/2

1. General

This instrument is applied when the signals from Minebea's digital load cell are summed up to 4(four) pieces.

2. Specifications

- P/No. B-307-※
- Protective construction IP54
- Clamping gland Flame resisting, dustproof, and waterproof type(Material : Nylon66)
- Applied cable diameter ϕ 6.5 mm or more , ϕ 8.5 mm or less for transducer application
over ϕ 8.5 mm , ϕ 10.5 mm or less for amplifier application
- Balance adjustment 4(four) points(for adjustment of bridge voltage)
- Paint color Mansell 5Y7/1
- Weight Approx. 0.9 kg

3. Parts No.

B-307-

①

| ①No. of adding points | |
|-----------------------|------------------|
| No. | Specification |
| 2 | Summing 2 points |
| 3 | Summing 3 points |
| 4 | Summing 4 points |

4. Options

- Tightening ground

| Suitable cable diameter | P/No. |
|---|----------|
| ϕ 6.5 mm or more , ϕ 8.5 mm or less | SCL-L10A |
| over ϕ 8.5 mm , ϕ 10.5 mm or less | SCL-L10B |
| Dammy ground | SCL-L10Z |

5. Outline dimensions

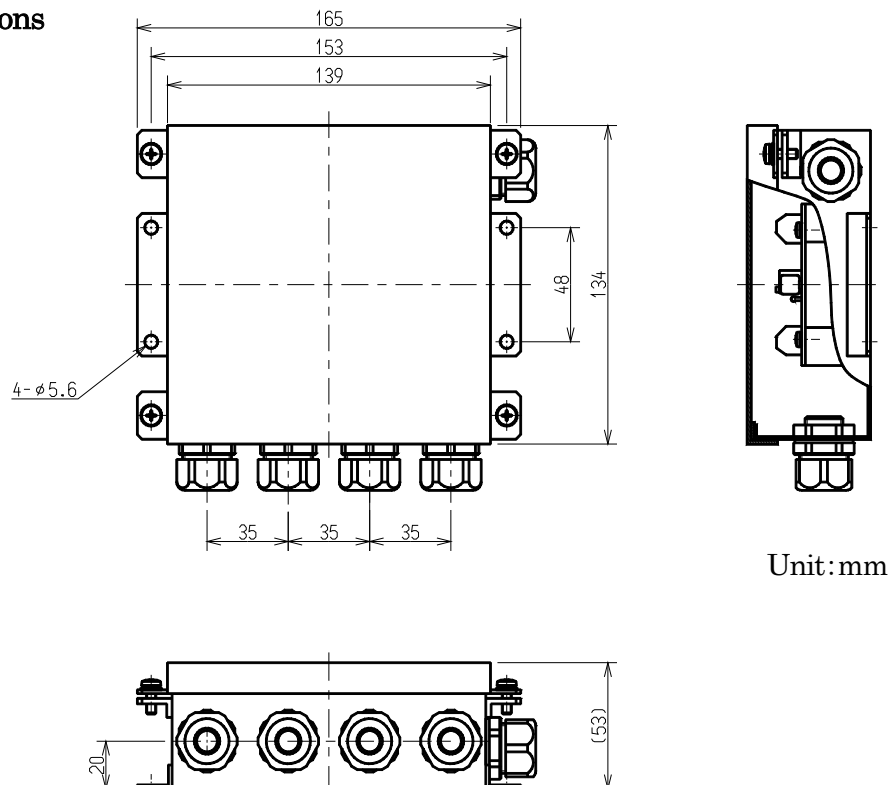

SPECIFICATIONS

B-307-※

SPEC.No. EN353307-E

2/2

6. Wiring diagram

6-1. Wiring of amplifier (The cable color is Minebea's standard color.)

| Terminal Name | Cable color of transducer | Remarks |
|---------------|---------------------------|---|
| RD | Red | |
| OR | Orange | The wiring for the OR and BK is unnecessary for the four-wire system. |
| BK | Black | |
| WH | White | |
| GN | Green | |
| BL | Blue | |
| YE | Shield | |

6-2. Wiring of transducers (The cable color is Minebea's standard color.)

| Terminal Name | Cable color of transducer |
|----------------|---------------------------|
| W(1W,2W,3W,4W) | White |
| R(1R,2R,3R,4R) | Red |
| G(1G,2G,3G,4G) | Green |
| B(1B,2B,3B,4B) | Blue |
| Y(1Y,2Y,3Y,4Y) | Shield (Yellow) |

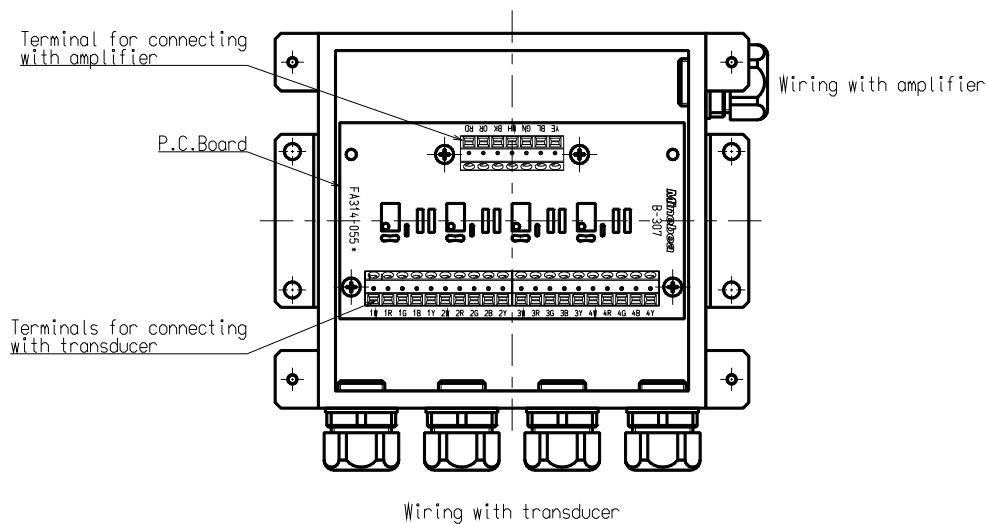

※Specifications and outline dimensions and so on which have printed may subject to change for the purpose of improvement without notice.