

# DIX42(10W Low inertia)

2023/03/22

## Overview



- dia. 42 × L41 DC Brushless motor inner rotor type
- Motor Type : 3 Phase DC Brushless Motor
- Direction of Rotation : CW and CCW
- Driver circuit built-in.
- Speed control by PWM DUTY.
- Compact, Light Weight and High Output
- High Efficiency
- Low Inertia
- Overcurrent and Locked Rotor Protection
- There is an encoder installation type. (DIA42B10)
- The gear machined output, shaft type is available as an option.

## Overall View

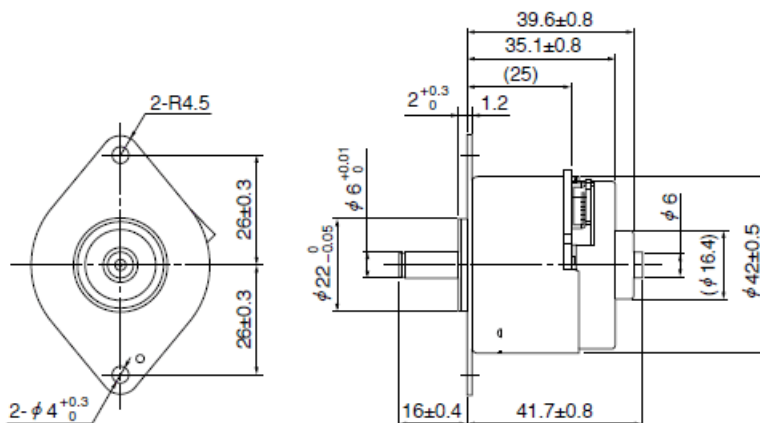

ミネベアミツミ株式会社

Copyright©MinebeaMitsumi Inc. All right reserved.

## DIX42(10W Low inertia)

2023/03/22

## Major Characteristic Parameters

Operating Voltage (for Motor) Min. [VDC]	21.6
Operating Voltage (for Motor) Nom. [VDC]	24
Operating Voltage (for Motor) Max. [VDC]	26.4
Operating Voltage (for Circuit) Min. [VDC]	4.5
Operating Voltage (for Circuit) Nom. [VDC]	5
Operating Voltage (for Circuit) Max. [VDC]	5.5
Continuous Rating Power Max. [W]	6
Short Time Rating Power Max. [W]	10
Rotor Inertia (Reference Value) Nom. [g · cm <sup>2</sup> ]	13
Operating Temperature Min. [deg.C]	0
Operating Temperature Nom. [deg.C]	20
Operating Temperature Max. [deg.C]	50
Operating Humidity Min. [%RH]	15
Operating Humidity	

# DIX42(10W Low inertia)

2023/03/22

Max. [%RH]	90
Usable Input PWM Duty Min. [%]	10
Usable Input PWM Duty Max. [%]	100
Motor Weight Max. [g]	150

Please contact our sales for detail specification & order lot QTY. (All custom product by customer's requirement)

## Property

