

DIX42(20W)

2023/03/22

Overview

dia. 42 × L46 DC Brushless motor inner rotor type

Motor Type : 3 Phase DC Brushless Motor

Direction of Rotation : CW and CCW

Driver circuit built-in.

Speed control by PWM DUTY.

Compact, Light Weight and High Output

High Efficiency

Low Inertia

Overcurrent and Locked Rotor Protection

There is an encoder installation type and geared type. (DIA42B20)

There is an geared type.

The gear machined output, shaft type is available as an option.

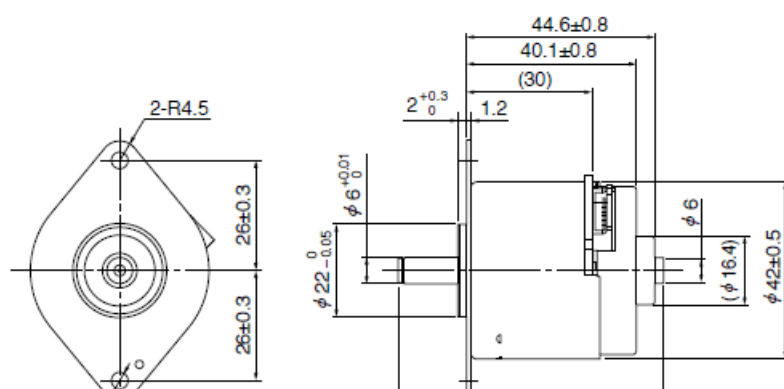
Overall View

ミネベアミツミ株式会社

Copyright©MinebeaMitsumi Inc. All right reserved.



Major Characteristic Parameters

Operating Voltage (for Motor) Min. [VDC]	21.6
Operating Voltage (for Motor) Nom. [VDC]	24
Operating Voltage (for Motor) Max. [VDC]	26.4
Operating Voltage (for Circuit) Min. [VDC]	4.5
Operating Voltage (for Circuit) Nom. [VDC]	5
Operating Voltage (for Circuit) Max. [VDC]	5.5
Continuous Rating Power Max. [W]	12
Short Time Rating Power Max. [W]	20
Rotor Inertia (Reference Value) Nom. [g · cm ²]	20
Operating Temperature Min. [deg.C]	0
Operating Temperature Nom. [deg.C]	20
Operating Temperature Max. [deg.C]	50
Operating Humidity Min. [%RH]	15

DIX42(20W)

2023/03/22

Operating Humidity	
Max.	90
[%RH]	
Usable Input PWM Duty	
Min.	10
[%]	
Usable Input PWM Duty	
Max.	100
[%]	
Motor Weight	
Max.	185
[g]	

Please contact our sales for detail specification & order lot QTY. (All custom product by customer's requirement)

Property

