

SE18J

2023/03/22

Overview



Shape : Square
 Shaft Length : a = 12.8mm

Overall View

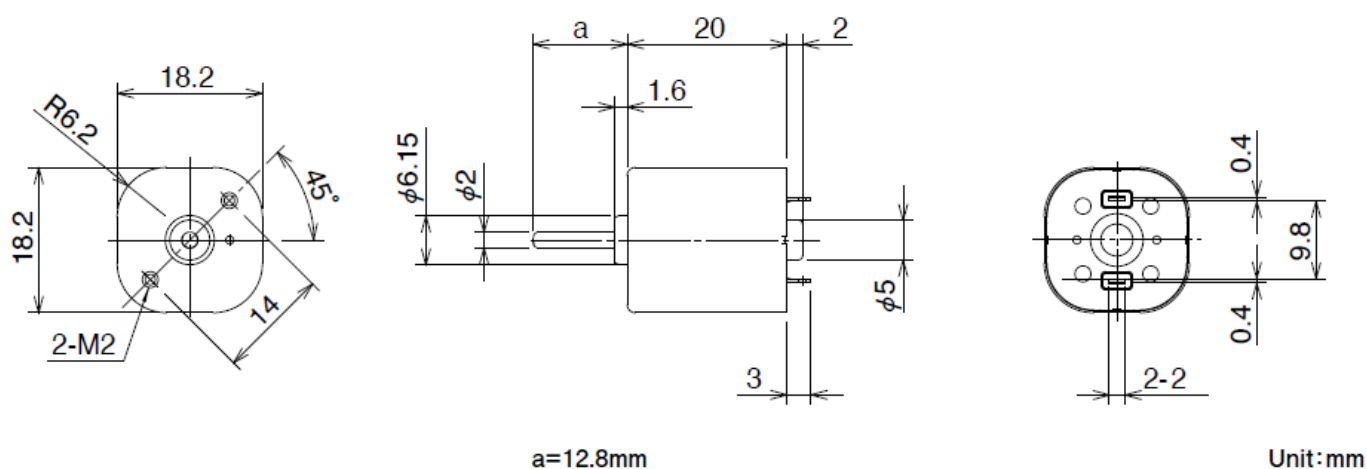

Specifications

Model	Operating Voltage lower limit [V]	Operating Voltage upper limit [V]	Rated Voltage [V]	No load speed [min ⁻¹]	No Load Current [mA]	Rated Load [gf·cm]

SE18J

2023/03/22

SE18J0TTY	8.0	13.0	12.0	3160	27.0	30.60	
SE18J1DTY	8.0	13.0	12.0	6360	67.0	40.80	
Model	Rated Load [mN · m]	Rated Load Speed [min ⁻¹]	Rated Load Current [mA]	Starting Torque [gf · cm]	Starting Torque [mN · m]	Starting current [mA]	Shaft Length [mm]
SE18J0TTY	3.00	2212	123	102.00	10.00	345	12.8
SE18J1DTY	4.00	5065	305	200.00	19.60	1230	12.8

Characteristics

