

# SG24P

2023/03/22

## Overview



## Overall View

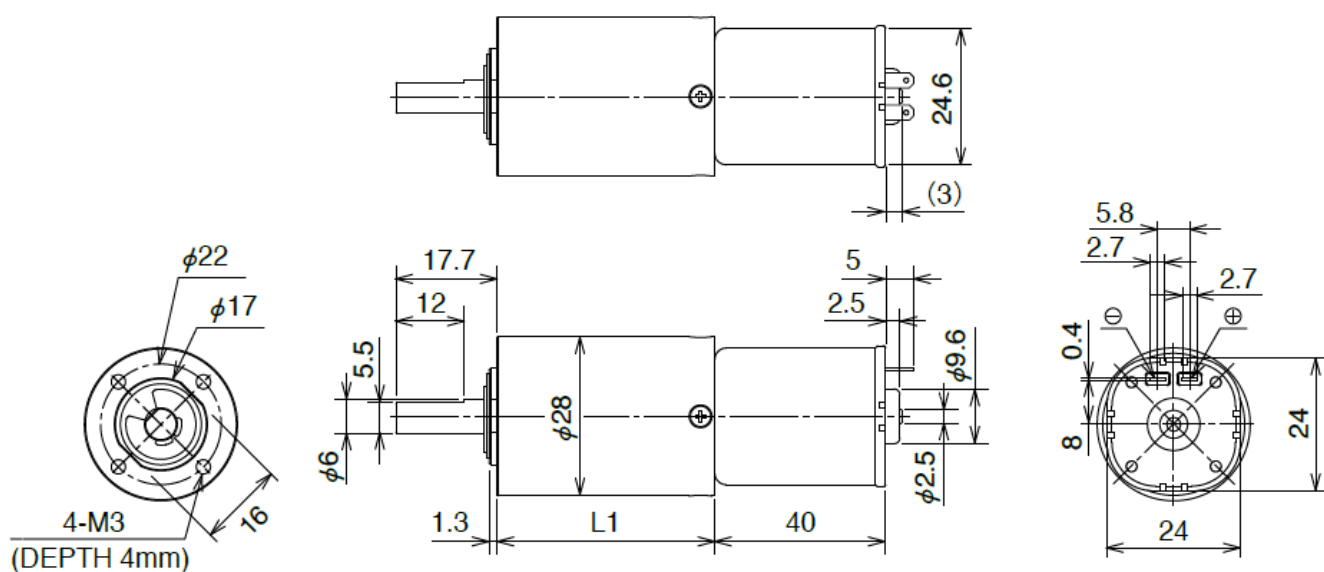

Unit:mm

## Specifications

Model	Rated Voltage [V]	No load speed [min-1]	No Load Current [mA]	Rated Load [gf·cm]	Rated Load [mN·m]	Rated Load Speed [min-1]
SG24P1TC	1.2	80	61.0	400.00	40.00	87

# SG24P

2023/03/22

SG24P1JTC	12.0	96	64.0	408.00	40.00	87
SG24P2NTC	12.0	94	257.0	7653.00	750.00	83

Model	Rated Load Current [mA]	Max Rated Load Torque [gf·cm]	Max Rated Load Torque [mN·m]	Starting Torque [gf·cm]	Starting Torque [mN·m]	Gear Ratio	Gear Step
SG24P1JTC	125	2243.000	220.0	4486.00	440.00	1:16	2
SG24P2NTC	1208	25492.000	2500.0	66281.00	6500.00	1:64	3

Model	Gear Box L1 [mm]	Weight [g]
SG24P1JTC	29.8	171.4
SG24P2NTC	38.3	201.0

## Characteristics

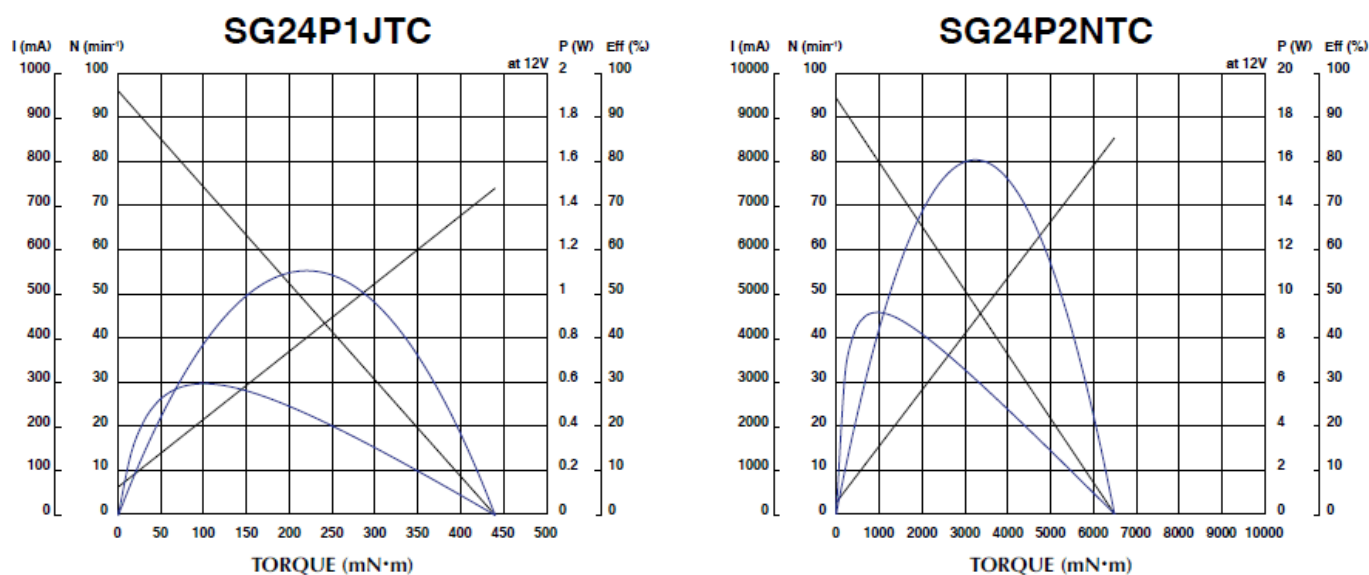

## NOTE

The final appearance shape and characteristics need to be discussed.  
 Depending on the required quantities, it might be difficult to accept the request.