

PL25L-A24

2024/02/28

Appearance

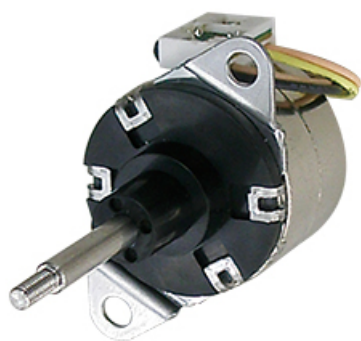

Reference Characteristics

Linear Force range lower limit [N]	1
Linear Force range upper limit [N]	50
Outer Diameter [mm]	25.0
Length [mm]	28.50
Step No.	24
Magnet Material	Nd-Fe-B bonded magnet(MS70)
Insulation Resistance (M) [Ω/min]	100
Dielectric Strength (AC) [V/min]	500
Drive Method	2-2 phase
Resistance [Ω]	14.7
Class of Insulation	CLASS B
Operating Temp. lower limit [deg.C]	0

PL25L-A24

2024/02/28

Operating Temp. upper limit [deg.C]	65
Storage Temp. lower limit [deg.C]	-30
Storage Temp. upper limit [deg.C]	80
Operating Hum. RH lower limit [%]	20
Operating Hum. RH upper limit [%]	90

Torque Characteristic

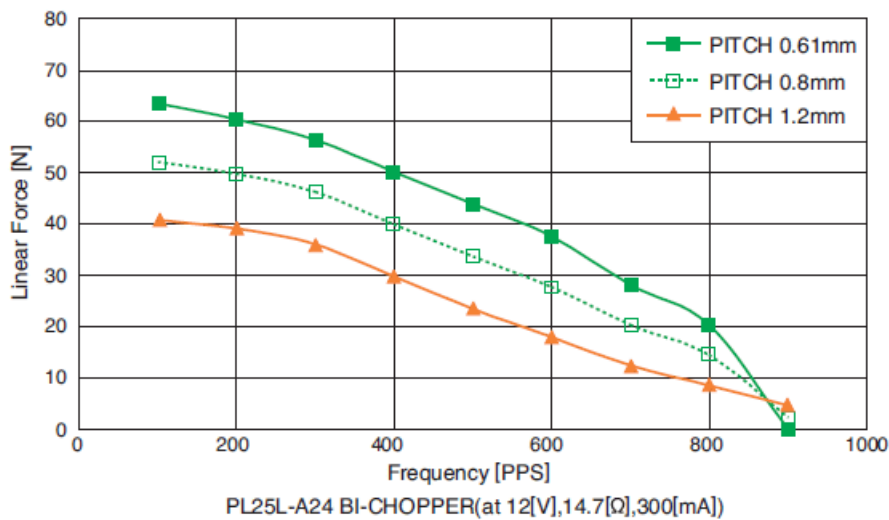

Overall View

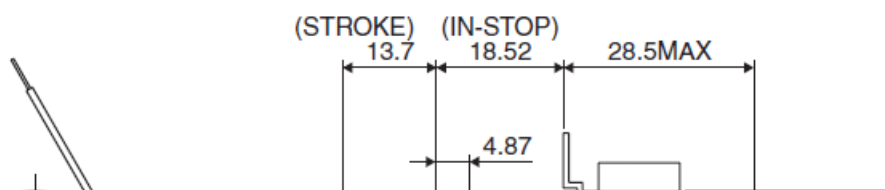

ミネベアミツミ株式会社

Copyright©MinebeaMitsumi Inc. All right reserved.

PL25L-A24

2024/02/28

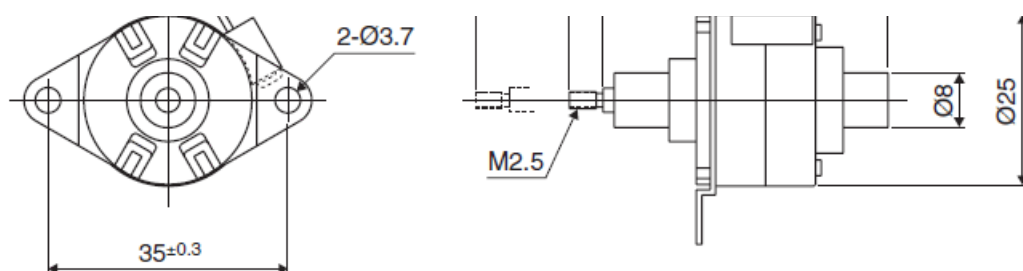

Specifications

Screw Pitch [mm]	Pitch/Step (at 2phase on) [mm/Step]	Drive Circuit	Drive Voltage [V]	Current/Phase [mA]	Drive IC
0.61	0.025	BIPOlar CHOPPER	12	300.0	UDN2916B-V
0.80	0.033	BIPOlar CHOPPER	12	300.0	UDN2916B-V
1.20	0.050	BIPOlar CHOPPER	12	300.0	UDN2916B-V

Applications

Industrial equipment: Flow control valves

Communication equipment: Antenna adjustment device

Automotive: Optic axis control device

Case Studies

PL25L-A24

2024/02/28

We can customize to meet your various requests! [Stepping motors]