

MMR906

2023/03/22

Outline

This product digitally outputs a pressure value which was corrected. Customers need no correction because it corrects and outputs the differences of sensors and temperature characteristics. It does not require complicated sensor drive or control circuit, and devices with high performance can be made only with this module and an external microcontroller which will be the host.

Applications

Blood pressure monitor for home appliance
Devices using air pressure

Features

- ① Small package 5.0(W) × 6.0(D) × 7.2(H)mm
- ② A high-accuracy pressure value can be output
Pressure resolution : 0.001mmHg
Effective resolution : 0.025mmHgRMS (3.4PaRMS)
Pressure accuracy : ±2.0mmHg (±267Pa)
- ③ It digitally outputs pressure value by a built-in sequencer (SPI)
- ④ Noise reduction is possible by a built-in second order low pass filter.

Main specifications

Pressure Type	Gage Pressure
Pressure Medium	Air (no Condensation)
Supply Voltage Range	1.7~2.6

MMR906

2023/03/22

[V]	1.7~3.0
Operating Temperature Range [deg.C]	0~60
Operating Pressure Range [kPa]	-4~48
Current Consumption [μA]	640
Pressure accuracy [Pa]	±266
Pressure effective resolution [PaRMS]	6.7 / 4.7 / 3.3 / 0.9
Conversion Time [ms]	4.1 / 7.9 / 15.6 / 247.0
Interface	SPI

Package

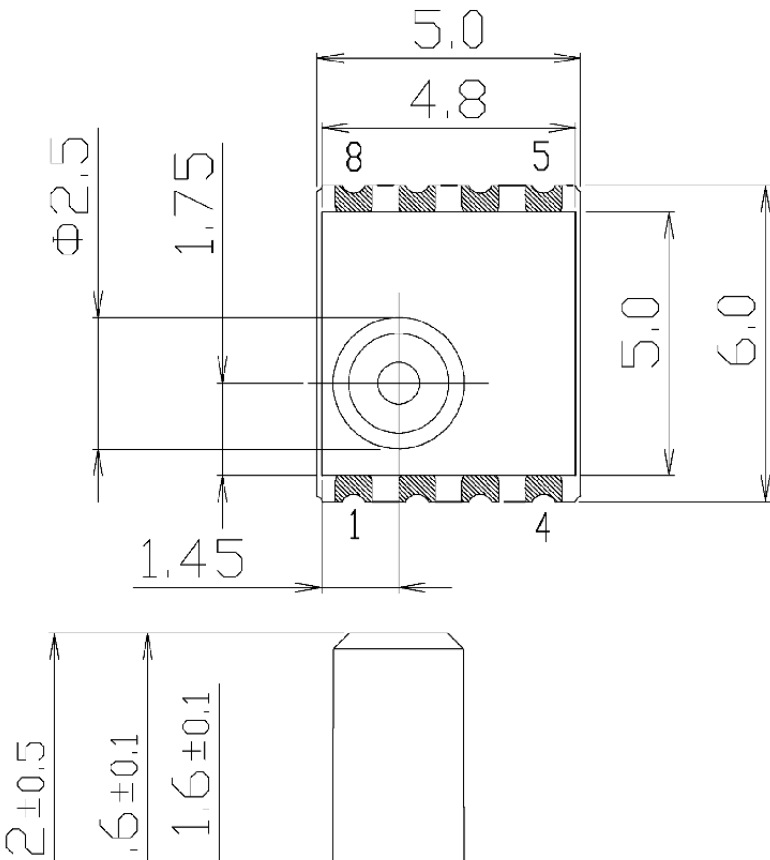

MMR906

2023/03/22

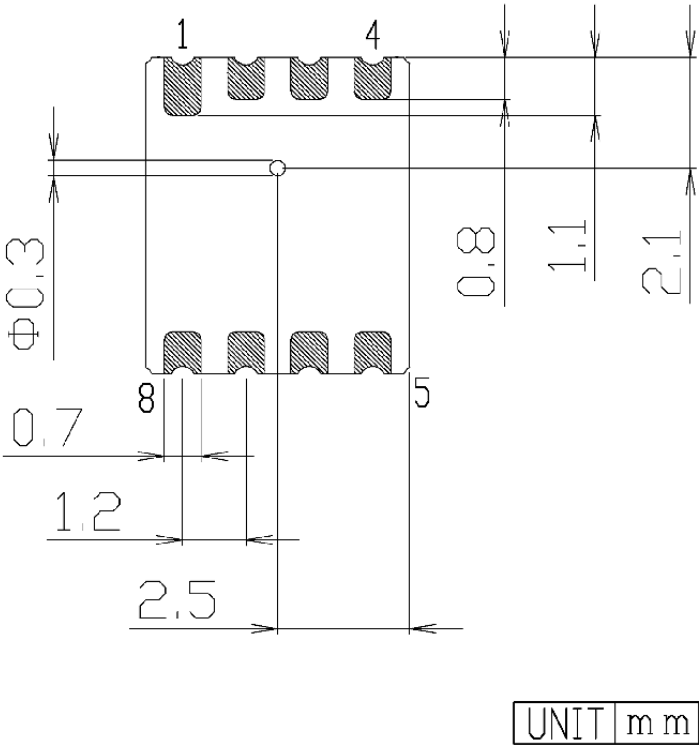
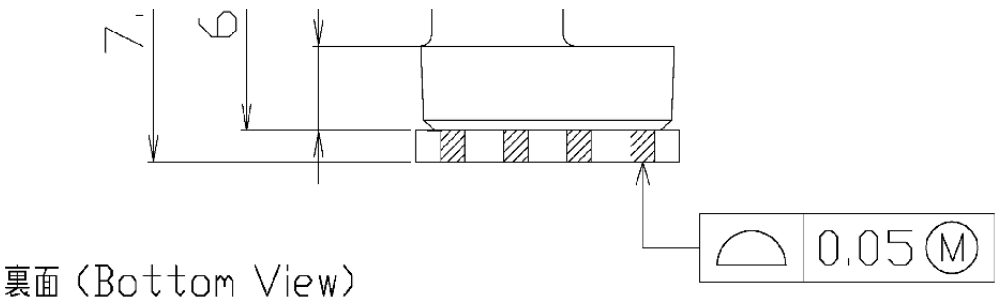

Package Size [mm]

5.0 x 6.0 x 7.2